

SPIRAL CABLE COMPONENTS

RS

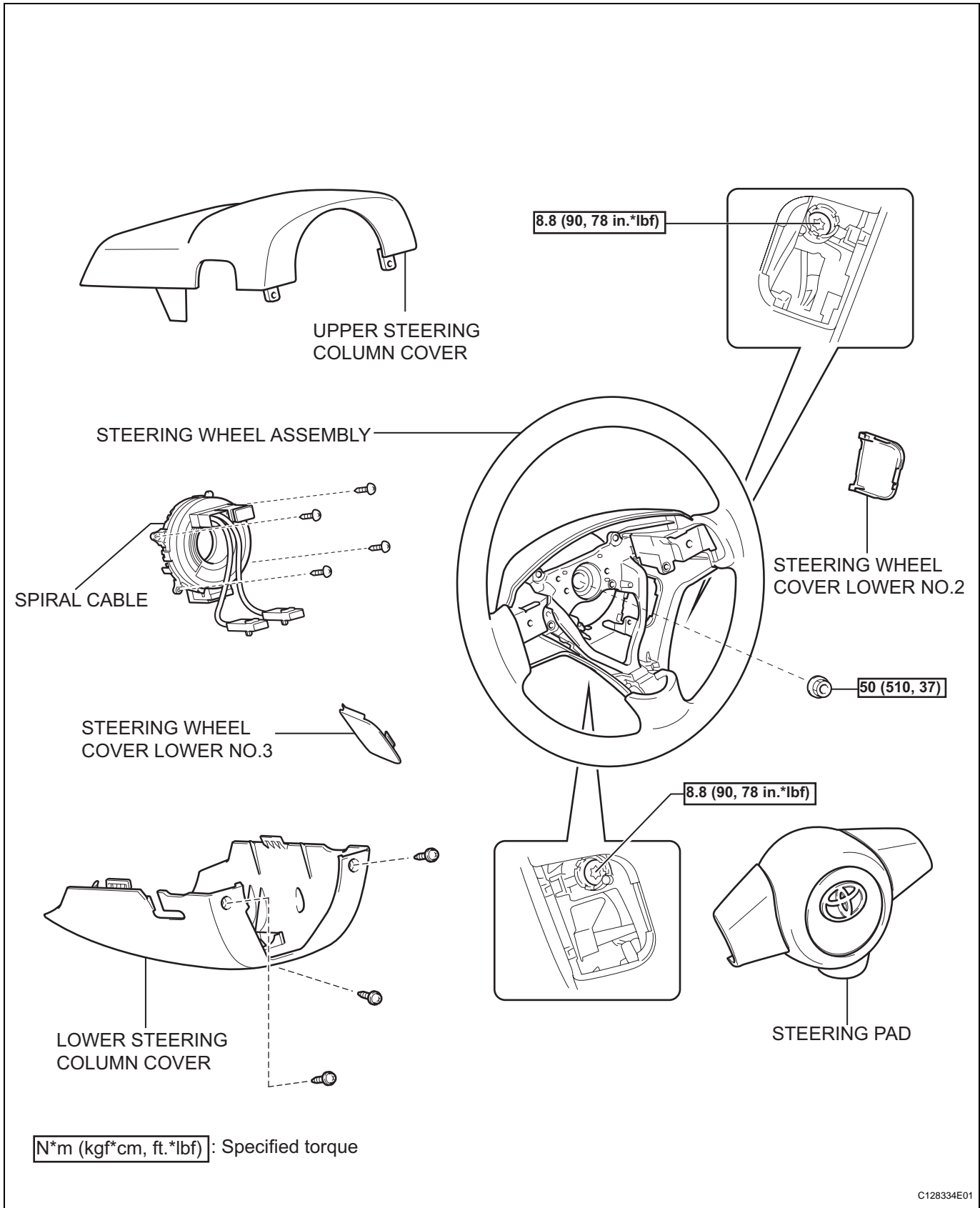

REMOVAL

1. **PRECAUTION**
CAUTION:
 Read "PRECAUTION" thoroughly before servicing (See page [RS-1](#)).
2. **DISCONNECT CABLE FROM NEGATIVE BATTERY TERMINAL**
CAUTION:
 Wait for at least 90 seconds after disconnecting the cable to prevent the airbag from working.
3. **PLACE FRONT WHEELS FACING STRAIGHT AHEAD**
4. **REMOVE STEERING WHEEL COVER LOWER NO.3**
 (See page [RS-345](#))
5. **REMOVE STEERING WHEEL COVER LOWER NO.2**
 (See page [RS-345](#))
6. **REMOVE STEERING PAD** (See page [RS-346](#))
7. **REMOVE STEERING WHEEL ASSEMBLY** (See page [SR-8](#))
8. **REMOVE LOWER STEERING COLUMN COVER** (See page [SR-8](#))
9. **REMOVE UPPER STEERING COLUMN COVER** (See page [SR-8](#))
10. **REMOVE SPIRAL CABLE**
 - (a) Disconnect the connectors from the spiral cable.
NOTICE:
When handling the airbag connector, take care not to damage the airbag wire harness.

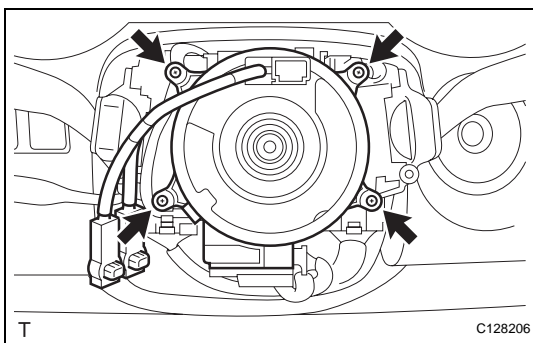
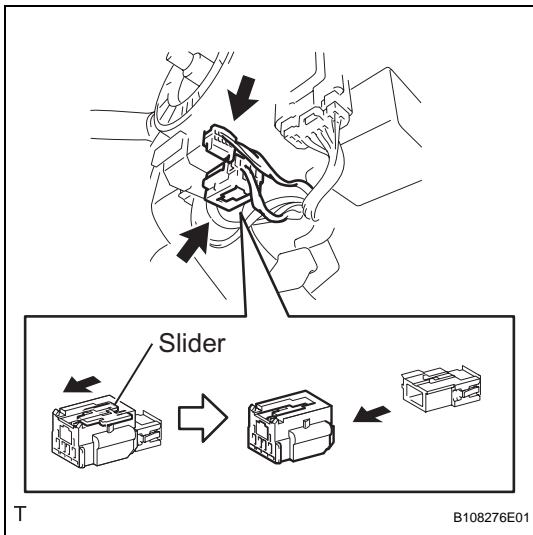

- (b) Disengage the 4 screws and remove the spiral cable.